

# SUPERHEAVY ASSAULT WALKER ASSEMBLY INSTRUCTIONS

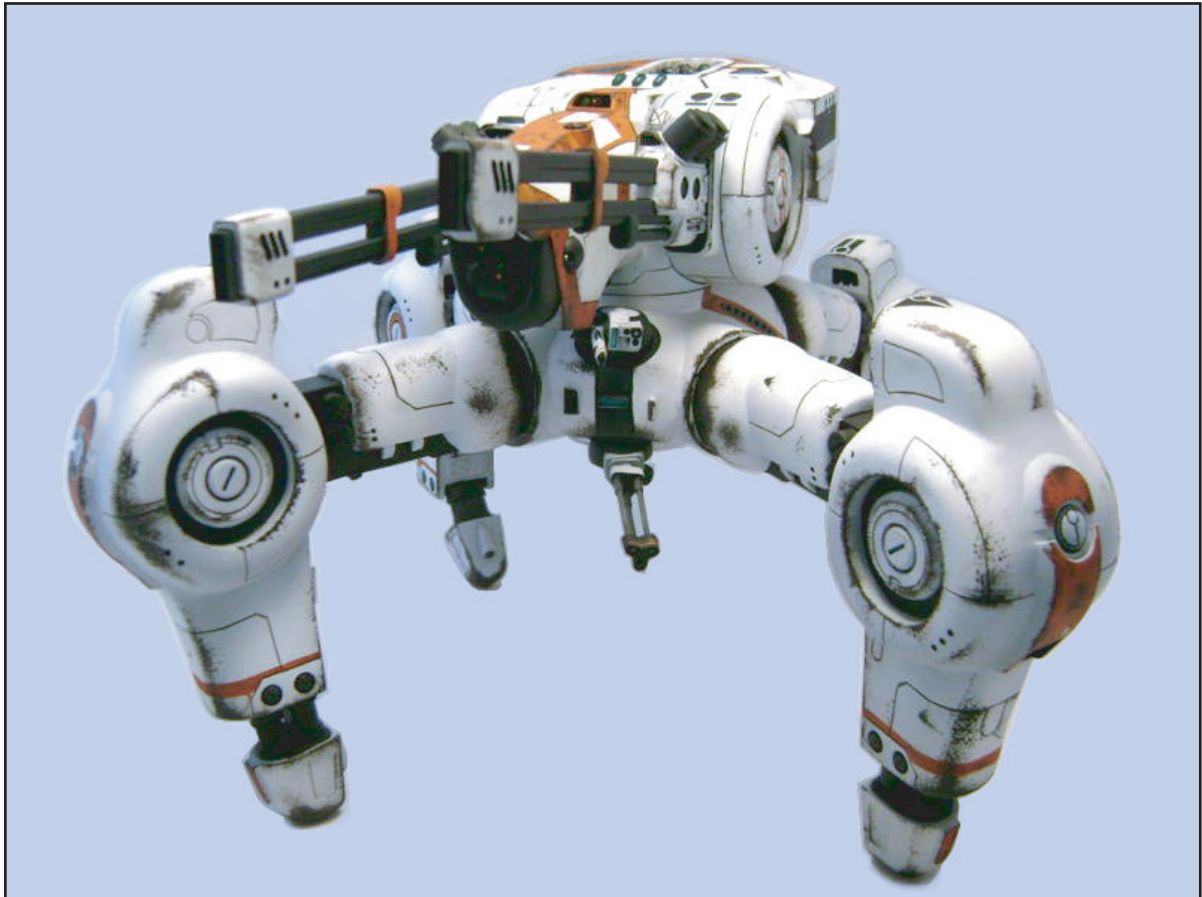

Model painted by Mark Tait

This kit is made from resin parts, which may be coated in a wax based release agent (used to help release the parts from the moulds during production). It is recommended that all parts be washed prior to assembly to remove this release agent

All parts will require cleaning up and assembly using an intermediate collection of modelling tools, including knife, saw, files, sandpaper, epoxy putty and glue. A two-part epoxy glue is recommended for large joints such as the hips.

WARNING: RESIN DUST CAN BE HARMFUL TO THE LUNGS - ALWAYS WEAR APPROPRIATE PROTECTIVE EQUIPMENT WHEN WORKING WITH RESIN PARTS, AND ENSURE THAT THE DUST IS NOT ALLOWED TO BLOW AWAY FROM THE WORK AREA. ALWAYS CLEAN UP APPROPRIATELY AFTER WORKING WITH RESIN PARTS.

# SUPERHEAVY ASSAULT WALKER ASSEMBLY INSTRUCTIONS

## Page 1 - LEG

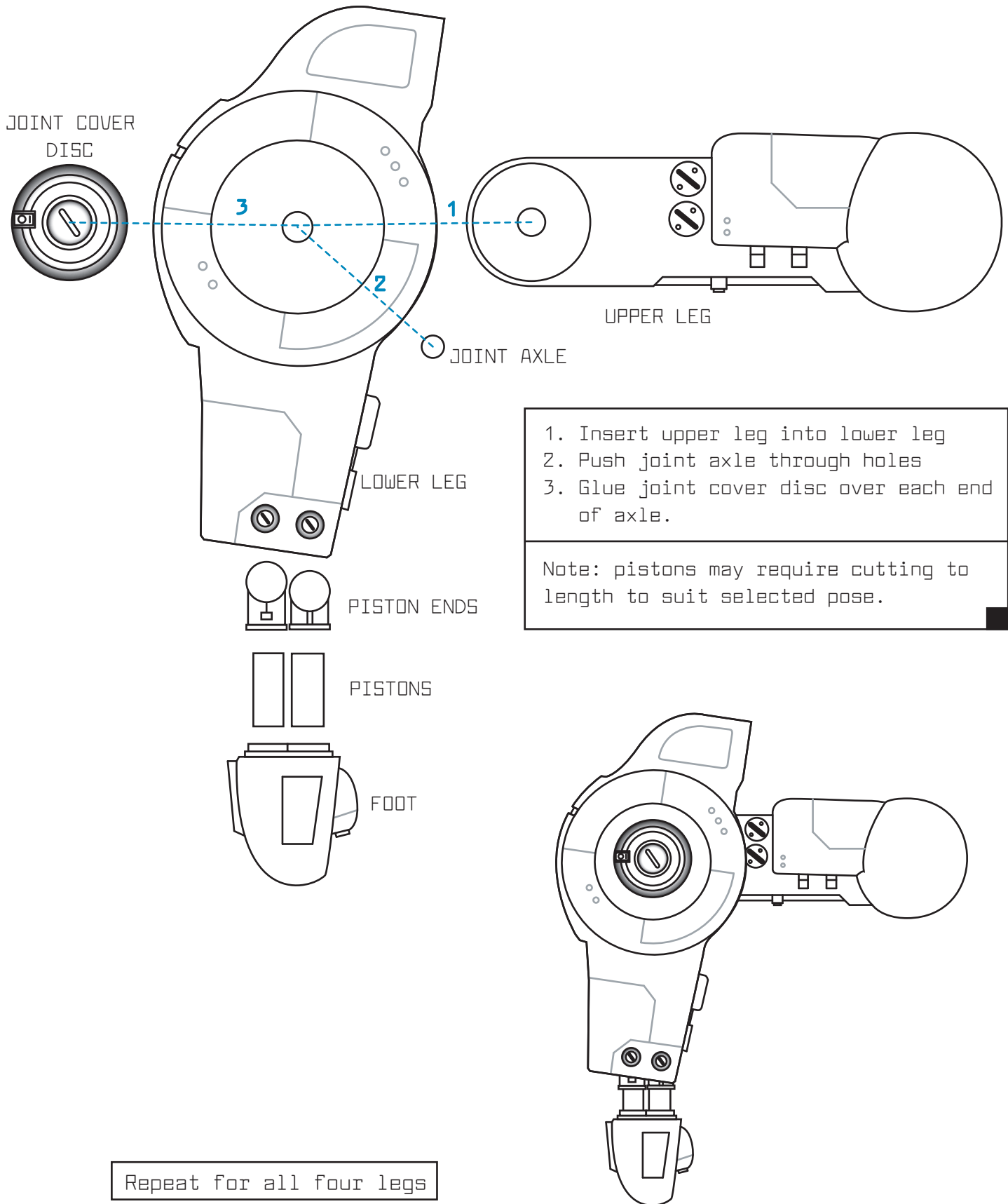

RAILGUN  
ROTATOR

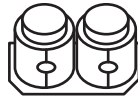
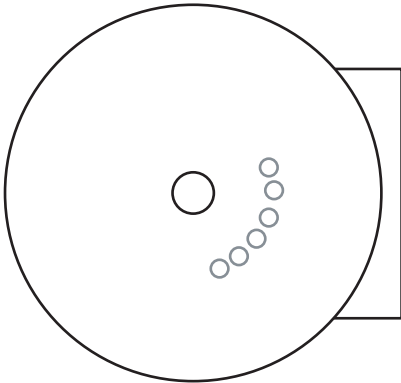

CAPACITOR BLOCK



RAILGUN

Note: Left and right side assemblies use same parts assembled as mirror images.

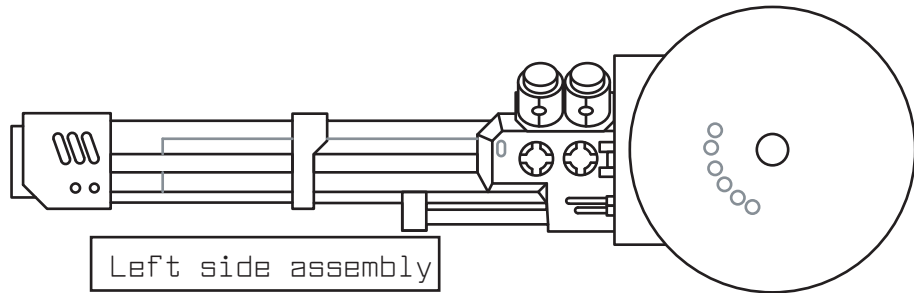

Left side assembly

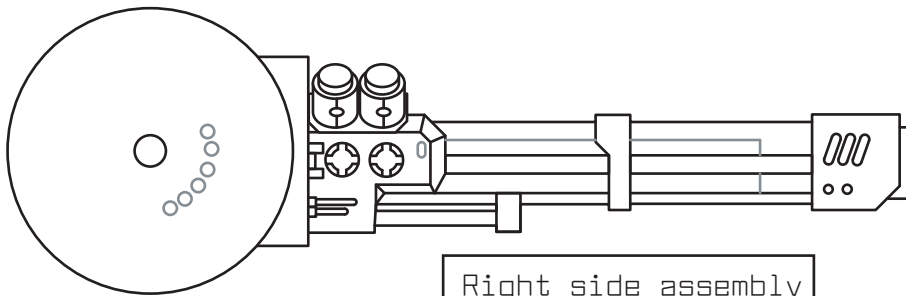

Right side assembly

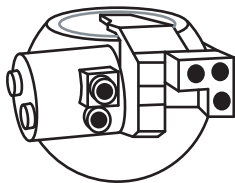

LASER MARKER TURRET

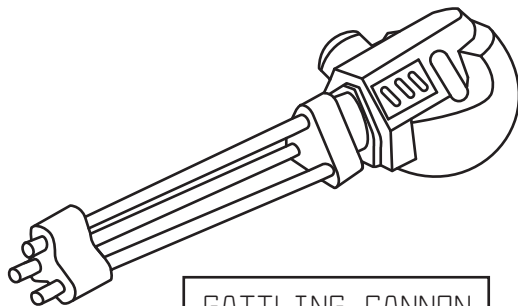

GATTLING CANNON

# SUPERHEAVY ASSAULT WALKER ASSEMBLY INSTRUCTIONS

## Page 3 - CHASSIS

Do not glue railgun assemblies into place. They should rotate freely on the rotator axle and will be held in place using the rotator ends.

Ensure that the square peg on the bottom of the rear chassis is inserted into the matching hole on the front chassis.

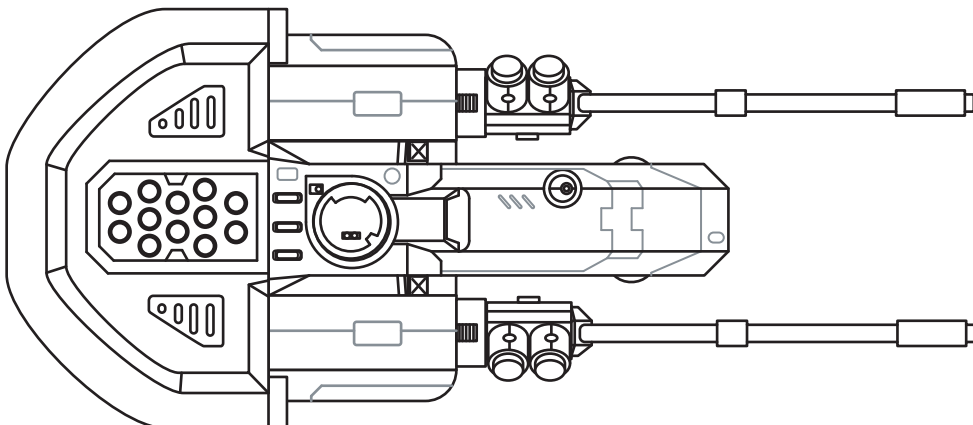
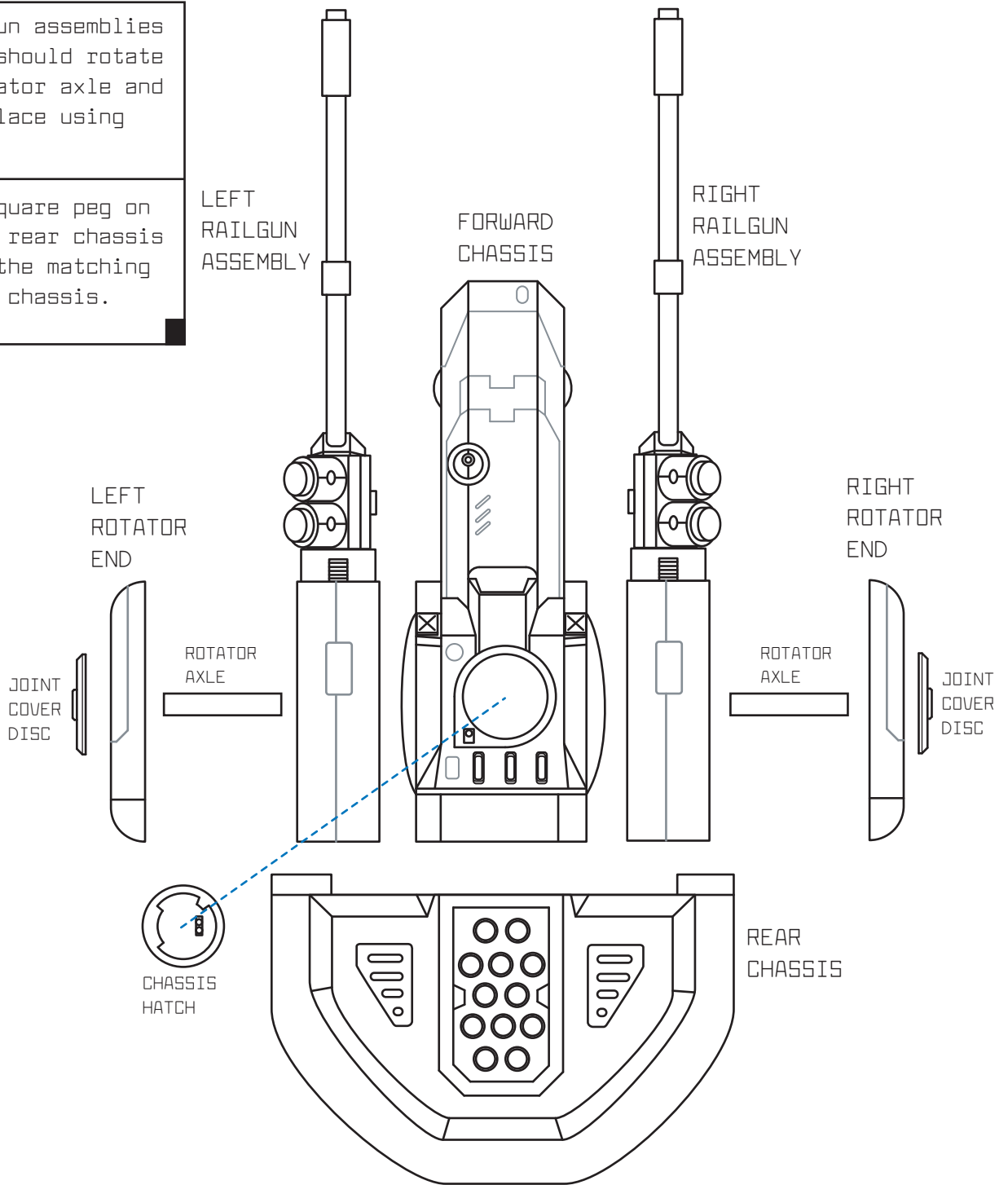

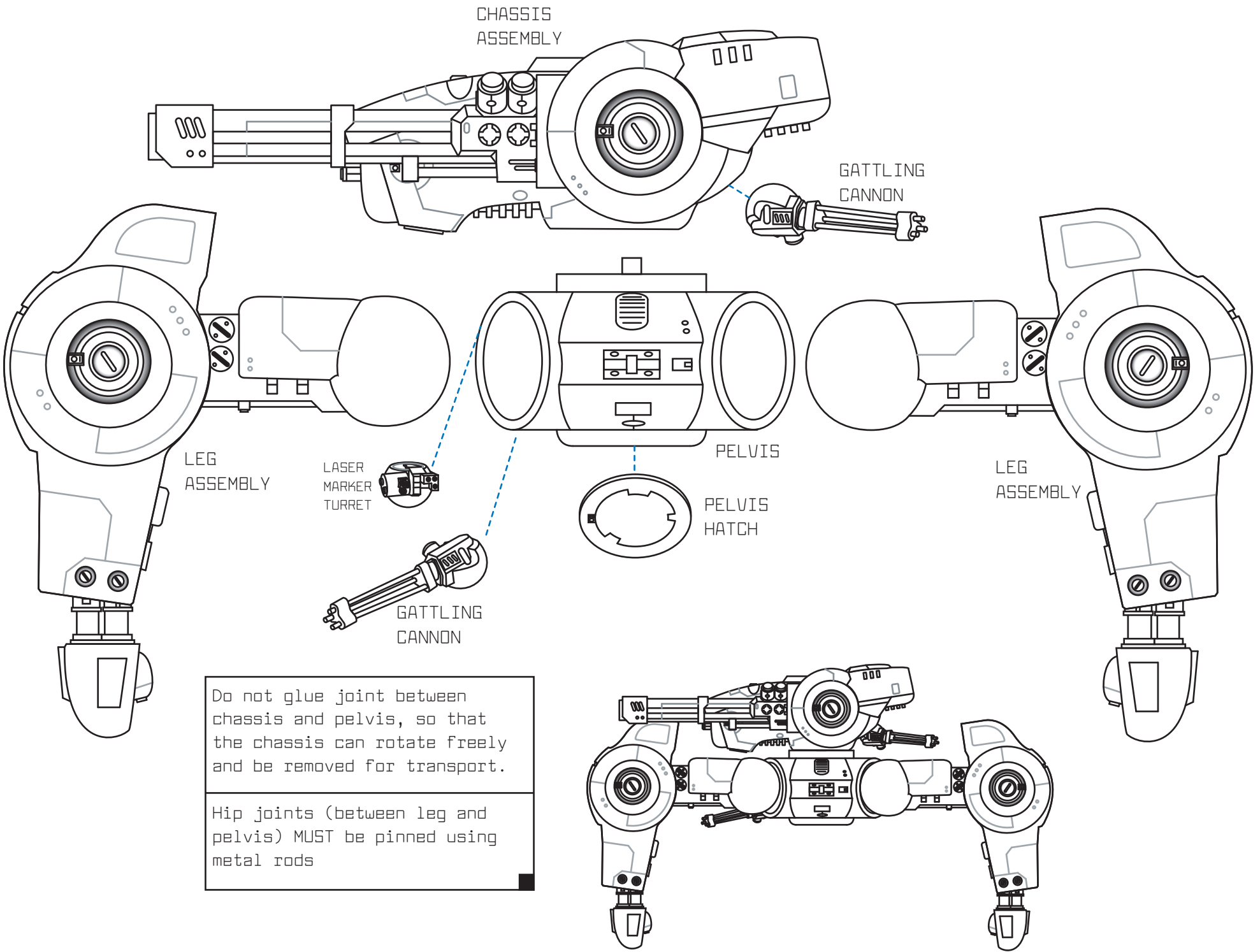

Do not glue joint between chassis and pelvis, so that the chassis can rotate freely and be removed for transport.

Hip joints (between leg and pelvis) MUST be pinned using metal rods